

OKLAHOMA DEPARTMENT OF TRANSPORTATION					
FED. ROAD DIST. NO.	STATE	PROJ. NO.	FISCAL YEAR	SHEET NO.	TOTAL SHEETS
	OKLA.				
DESCRIPTION		REVISIONS	DATE		



Network Adjustment
 www.MOVIT3.com
 (c) 1999-2010 Geotrij
 Licensed to Leica Geosystems AG
 Created: 03/13/2013 10:42:04

Project Information

Project name: 12June2013
 Date created: 06/13/2013 08:35:45
 Time zone: -5h 00'
 Coordinate system name: OK N NAD83 CDS
 Application software: LEICA Geo Office B.0
 Processing format: MOVIE3 4.0.4

General Information

Adjustment
 Type: Weighted constrained
 Observation: 30
 Coordinate system: NGS 1984
 Height datum: Ellipsoid
 Number of iterations: 1
 Maximum coord correction in last iteration: 0.0000 ft (tolerance is met)

Stations
 Number of (fixed) known stations: 2
 Number of unknown stations: 2
 Total: 4

Observations
 GPS coordinate differences: 27 (9 baselines)
 Known coordinates: 8
 Total: 35

Unknowns
 Coordinates: 15
 Tors: 28
 Degrees of freedom: 15

Testing
 Alfa (multi-dimensional): 0.9739
 Alfa-B (one-dimensional): 7.0 %
 Beta: 90.0 %
 Sigma a priori (RMS): 10.0

Chi-Rest value W-test: 1.66
 Chi-Rest value T-test (2-dimensional): 2.42
 Chi-Rest value F-test (2-dimensional): 1.88
 Chi-Rest value F-test: 1.07
 F-test: 0.19 (accepted)

Results based on a posteriori variance factor

Adjustment Results

Coordinates

Station	Latitude	Longitude	Height	Corr	Sd
C-19-959	Latitude	39° 05' 59.41922" N	-0.8273 ft	-	0.0039 ft
	Longitude	99° 23' 58.2190" W	-0.9577 ft	-	0.0039 ft
	Height	686.8711 ft	1.0321 ft	-	0.1855 ft
C-19-960	Latitude	39° 09' 59.39803" N	-0.0077 ft	-	0.0039 ft
	Longitude	99° 24' 04.76004" W	-0.0018 ft	-	0.0039 ft
	Height	740.5701 ft	1.0321 ft	-	0.1855 ft
OKPR	Latitude	39° 18' 34.48478" N	0.0000 ft	-	fixed
	Longitude	97° 19' 37.97963" W	0.0000 ft	-	fixed
	Height	1072.0248 ft	1.8916 ft	-	0.1855 ft
OKTE	Latitude	39° 15' 26.69972" N	0.0000 ft	-	fixed
	Longitude	99° 53' 52.19775" W	0.0000 ft	-	fixed
	Height	666.1695 ft	1.0319 ft	-	0.1855 ft
OKTU	Latitude	39° 12' 38.11380" N	0.0000 ft	-	fixed
	Longitude	99° 51' 15.78259" W	0.0000 ft	-	fixed
	Height	597.1041 ft	1.9259 ft	-	0.1855 ft
P-59-270	Latitude	39° 09' 53.94858" N	-0.0079 ft	-	0.0040 ft
	Longitude	99° 24' 05.42081" W	-0.0078 ft	-	0.0039 ft
	Height	804.0150 ft	1.9321 ft	-	0.1855 ft

PT NO.	X-Coord.	Y-Coord.	Elev.
C-19-959	2440959.9594	422454.7849	778.28
C-19-960	2440397.2066	426453.1717	840.77
P-59-270	2440319.8274	427961.4889	895.42

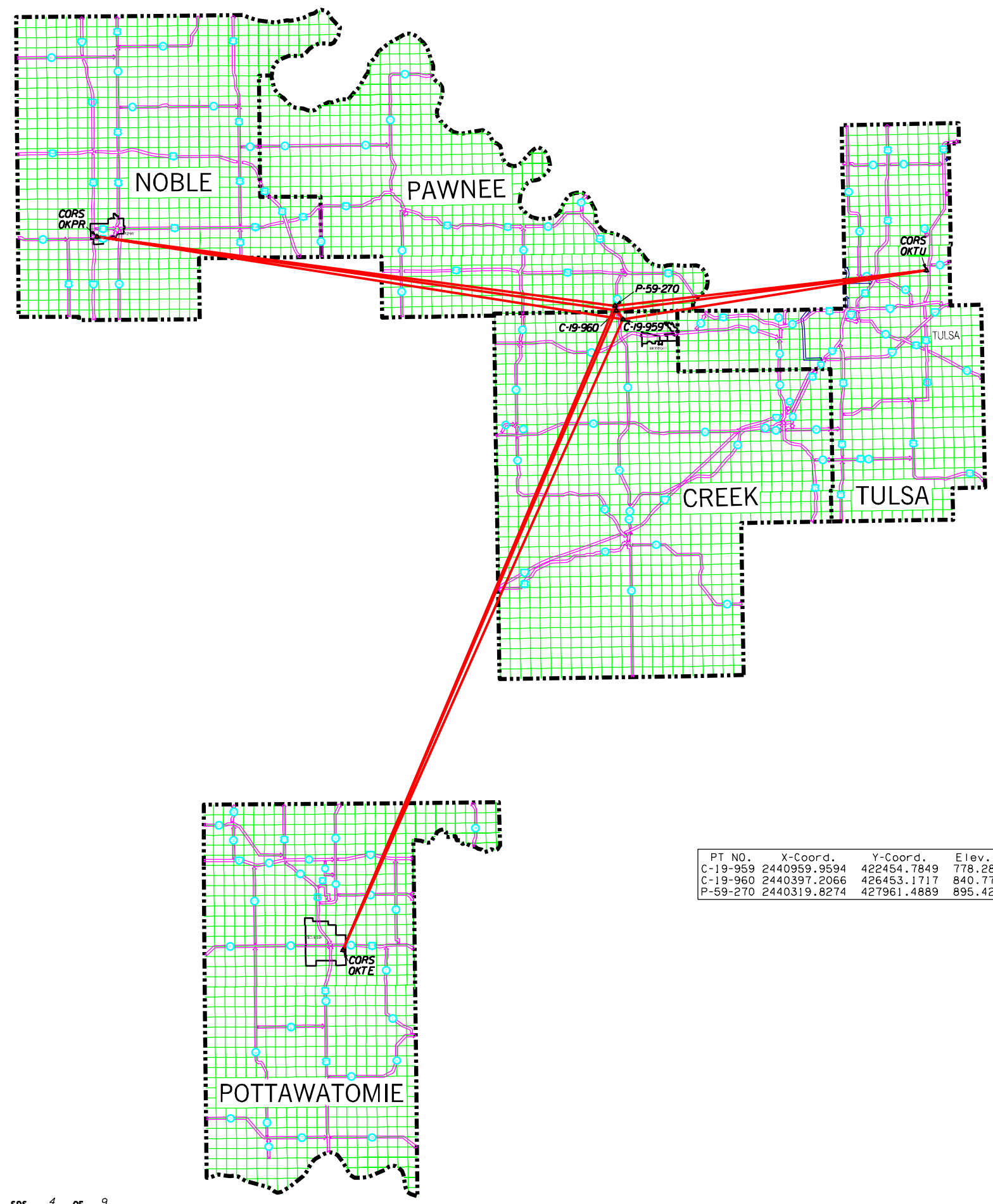

Scale:
1" = 100'

PLS	DEA	OKLAHOMA DEPARTMENT OF TRANSPORTATION SURVEY DIVISION
DRAWN	DEA	
CHECKED		
APPROVED	LGW	
CREW	Tecumseh	

SURVEY DATA SHEET

SWO 4994 (1) PROJECT NO. 27925(04) SHEET NO. S4